

Plans from [Saws N' Dust website](#)

External Torrit Filter Mounting for Dust Collection System

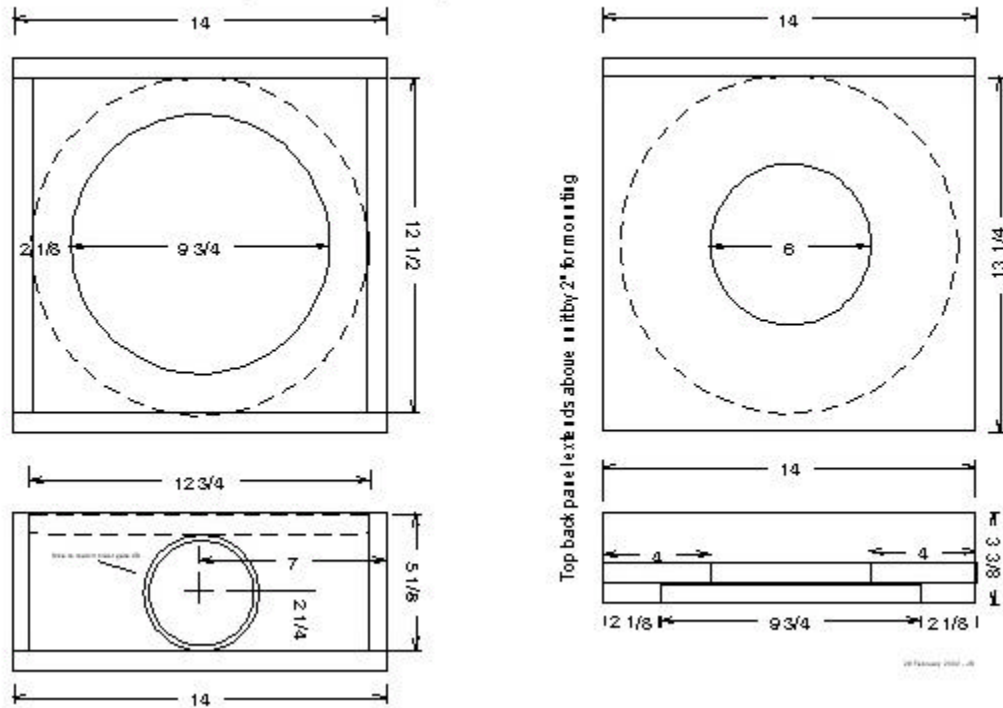

For anyone interested in building the plywood cleanout box and top mount for the Torrit (or similar filters), here is a dimensioned drawing. If you use a different filter, you will need to adjust the 9.75" dimension of the circles cut in both the base and the top mount. The rubber sealing ring on the filters just fits into this opening. The small hole in the front of the base is for a standard blast gate--be sure to measure your gate before cutting this hole. For an alternative idea, visit [Dizzy's web site](#) and check out his cyclone filter system that's similar in design, but uses a nice round sheet metal base. See the last photo on the page at his site for this aspect of the project.